



High-performance Ultra Range: gegarandeerd blijvend mooi

Het klassieke RVS staal heeft een fantastische uitstraling die niet verloren mag gaan. Toch blijkt het in zware omstandigheden lastig om corrosie te voorkomen.

Daarom zijn onze Ultra Range producten van ongeëvenaarde kwaliteit. Ze zijn extra bestand tegen vlekvorming en oneffenheden door corrosie. Dankzij toepassing van duurzame corrosiebestendige materialen is Ultra Range het aangewezen assortiment voor gebruik in zwembaden en kustgebieden. We zijn zelfs zo overtuigd van de kwaliteiten van Ultra Range dat we 2 jaar kwaliteitsgarantie* geven.

* Gegarandeerd 2 jaar lang corrosievrij, met inachtneming van onze voorwaarden.



Wand - buis

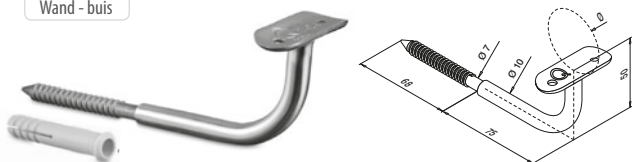

MOD 0110

2205			
OUTDOOR	Ø		
18.0110.042.12	42,4		2



MOD 0509

2205			
OUTDOOR			
18.0509.012.12			2

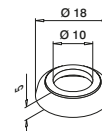

Wand - buis



MOD 0116

2205			
OUTDOOR	Ø		
18.0116.042.12	42,4		2



Buis - buis

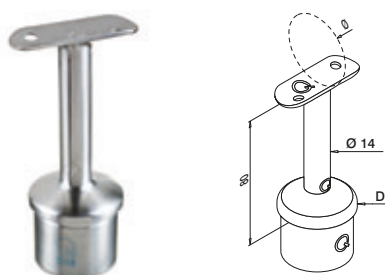

MOD 0690 - D = Ø 42,4 mm

2205			
OUTDOOR	D	Ø	
18.0690.242.12	42,4 x 2,0	42,4	2



Buis - buis

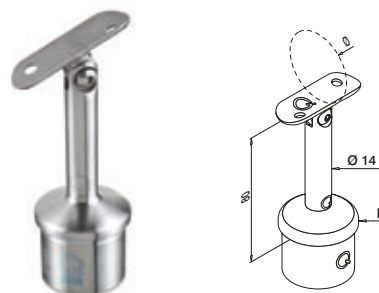

MOD 0698 - D = Ø 42,4 mm

2205			
OUTDOOR	D	Ø	
18.0698.242.12	42,4 x 2,0	42,4	2



Q-INFO MOD 0698 / 0690

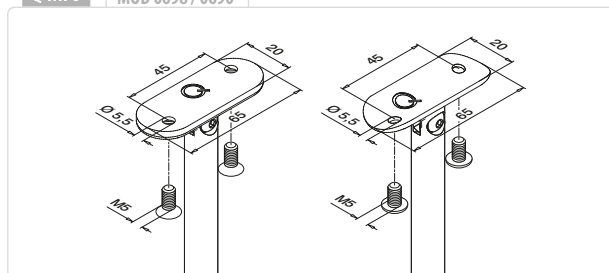

Q-INFO MOD 0110 / 0509

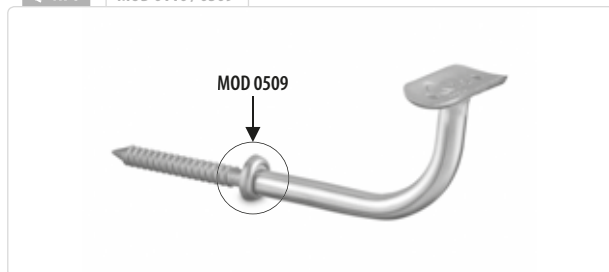

2205 = laag nikkelgehalte

Q-INFO



Q-23
Q-cleaner
300 ml
19.0601.000.00

Q-INFO



Q-22
Q-ultra-clean
500 ml
19.0610.000.00

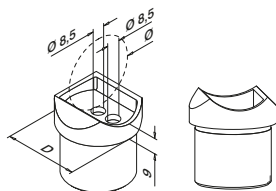

Buis - buis

**MOD 0772** - D = Ø 42,4 mm

2205

OUTDOOR	D	Ø	
18.0772.242.12	Ø 42,4 x 2,0	42,4	2



Buis - buis

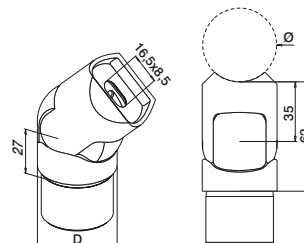

0-70°

**MOD 0776** - D = Ø 42,4 mm

2205

OUTDOOR	D	Ø	
18.0776.242.12	Ø 42,4 x 2,0	42,4	2



Balusters

GESLEPEN

ULTRA RANGE - Balusters en toebehoren

Complete set

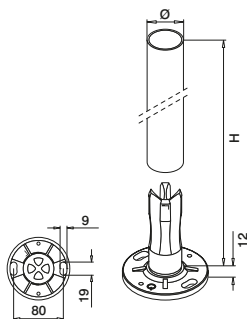
**MOD 0950**

2205

OUTDOOR	Ø	H		
18.0950.242.12	42,4 x 2,0	970	QS-500 352	1

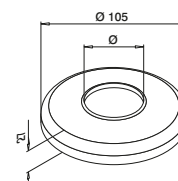
**MOD 0510**

2205

OUTDOOR	Ø	
18.0510.042.12	42,4	2

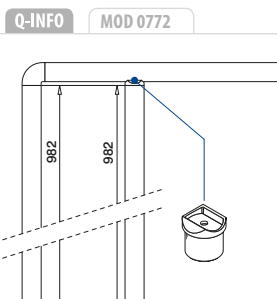

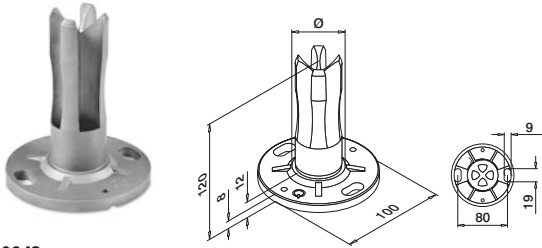
**MOD 0942**

2205

OUTDOOR

18.0942.242.00	42,4 x 2,0	Q5-500	352	2
----------------	------------	--------	-----	---

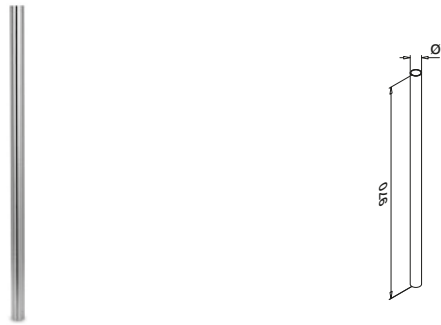

International Design Model Protection

**MOD 3901**

2205

OUTDOOR

18.3901.242.12	42,4 x 2,0			1
----------------	------------	--	--	---

Q-INFO

MOD 0942

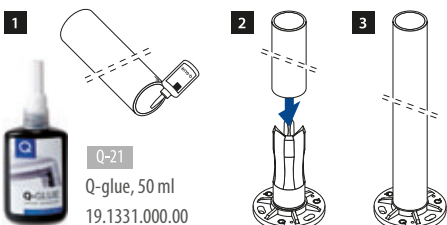

Q-21
Q-glue, 50 ml
19.1331.000.00

Q-INFO



Q-23
Q-cleaner
300 ml
19.0601.000.00

Q-INFO



Q-22
Q-ultra-clean
500 ml
19.0610.000.00

**MOD 0927**

2205

OUTDOOR

	Ø	H1	H2	H3	
18.0927.242.12	42,4 x 2,0	175	850	120	1

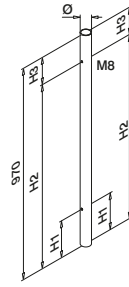
**MOD 0928**

2205

OUTDOOR

	Ø	H1	H2	H3	
18.0928.242.12	42,4 x 2,0	175	850	120	1

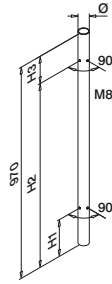
**MOD 0929**

2205

OUTDOOR

	Ø	H1	H2	H3	
18.0929.242.12	42,4 x 2,0	175	850	120	1

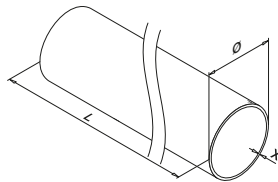
**MOD 0900 / 8925 - Ø 42,4 mm**

2205

OUTDOOR

	Ø	X	
18.8925.242.12	42,4	2,0	L = 2500 mm
18.0900.242.12	42,4	2,0	L = 5000 mm

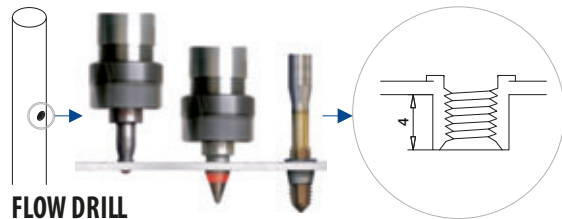
**Q-INFO** MOD 0927 / 0928 / 0929**FLOW DRILL****Q-INFO** MOD 0900 / 8925

Berekeningsbasis voor buizen

calculated by **ONDRA**

	Ø (mm)	A (cm ²)	I _x (cm ⁴)	I _y (cm ⁴)	W _x (cm ³)	W _y (cm ³)	M (kg/m)	R _{p0,2} (kN/cm ²)	R _m (kN/cm ²)
18.0900.242.12	42,4	2,58	2,80	5,11	1,66	2,41	2,02	48	66
18.8925.242.12									

A = oppervlakte dwarsdoorsnede
 I_x / I_y = oppervlaktetraagheidsmoment
 W_x / W_y = weerstandsmoment
 M = massa
 R_{p0,2} = toelaatbare spanning
 R_m = minimale trekvastheid

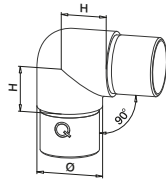

MOD 0303 - Ø 42,4 mm

2205

OUTDOOR	Ø	H	
18.0303.242.12	42,4 x 2,0	30	2



0 - 70°

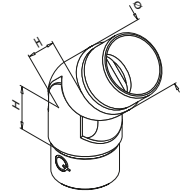

MOD 0312 - Ø 42,4 mm

2205

OUTDOOR	Ø	H	
18.0312.242.12	42,4 x 2,0	27	2



International Design Model Protection

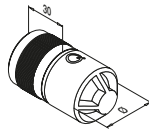

MOD 5792 - Ø 42,4 mm

2205

OUTDOOR	Ø	
18.5792.242.00	42,4 x 2,0	2



International Design Model Protection

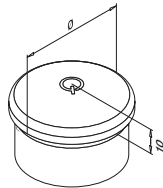

MOD 0730 - Ø 42,4 mm

2205

OUTDOOR	Ø	
18.0730.242.12	42,4 x 2,0	2



Q-INFO

MOD 5792

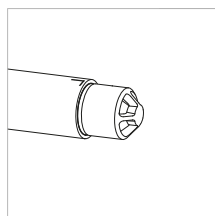
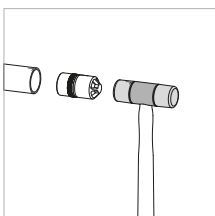

Q-21
Q-glue
50 ml
19.1331.000.00

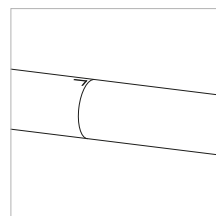

Q-INFO



Q-22
Q-ultra-clean
500 ml
19.0610.000.00



Buis

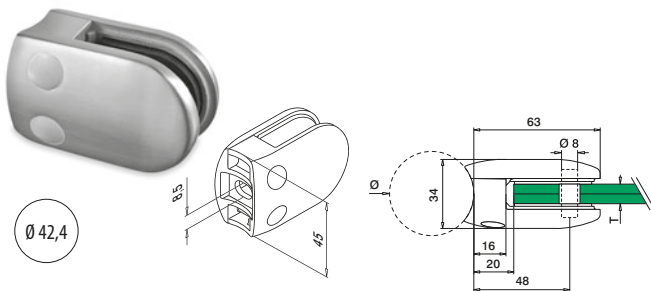

Borgpennen voor glasklemmen, optioneel te gebruiken voor MOD 28

MOD 5015

2205			
OUTDOOR	Voor model	L	
19.5015.022.18	MOD 28	22	4

MOD 28

MONO	2205			
	OUTDOOR	Ø	T	
	18.2806.042.12	42,4	6	4
	18.2808.042.12	42,4	8	4
	18.2810.042.12	42,4	10	4
NEW	18.2812.042.12	42,4	12	4

LAM.	2205			
	OUTDOOR	Ø	T	
	18.2807.042.12	42,4	6,76 (3 - 0,76 - 3)	4
	18.2841.042.12	42,4	8,38 (4 - 0,38 - 4)	4
	18.2809.042.12	42,4	8,76 (4 - 0,76 - 4)	4
	18.2844.042.12	42,4	9,52 (4 - 1,52 - 4)	4
NEW	18.2811.042.12	42,4	10,76 (5 - 0,76 - 5)	4
NEW	18.2854.042.12	42,4	11,52 (5 - 1,52 - 5)	4
NEW	18.2813.042.12	42,4	12,76 (6 - 0,76 - 6)	4



International Design Model Protection

Toebehoren

Rubbens voor glasklemmen



Rubbens voor glasklemmen

MOD 50

	MOD	T	Stuks per glasklem	
	19.5001.006.00	28	6	2 8
	19.5001.007.00	28	6,76 (3 - 0,76 - 3)	2 8
	19.5001.008.00	28	8	2 8
	19.5001.041.00	28	8,38 (4 - 0,38 - 4)	2 8
	19.5001.009.00	28	8,76 (4 - 0,76 - 4)	2 8
	19.5001.044.00	28	9,52 (4 - 1,52 - 4)	2 8
	19.5001.010.00	28	10	2 8
NEW	19.5001.011.00	28	10,76 (5 - 0,76 - 5)	2 8
NEW	19.5001.054.00	28	11,52 (5 - 1,52 - 5)	2 8
NEW	19.5001.012.00	28	12	2 8
NEW	19.5001.013.00	28	12,76 (6 - 0,76 - 6)	2 8

Borgpennen en bevestigingsmateriaal dienen apart te worden besteld.

Q-INFO MOD 5015

